

REVISIONS					
REV.	ECO NO.	DESCRIPTION OF CHANGE	REVISED BY	APPROVED BY	DATE
A	315-051	INITIAL RELEASE.	J.LOBERT	R.BERTZ	01/30/2015
B	316-497	COMPLETE REDRAW.	J.LOBERT	R.BERTZ	12/20/2016

CL-711 STANDARD CONFIGURATION

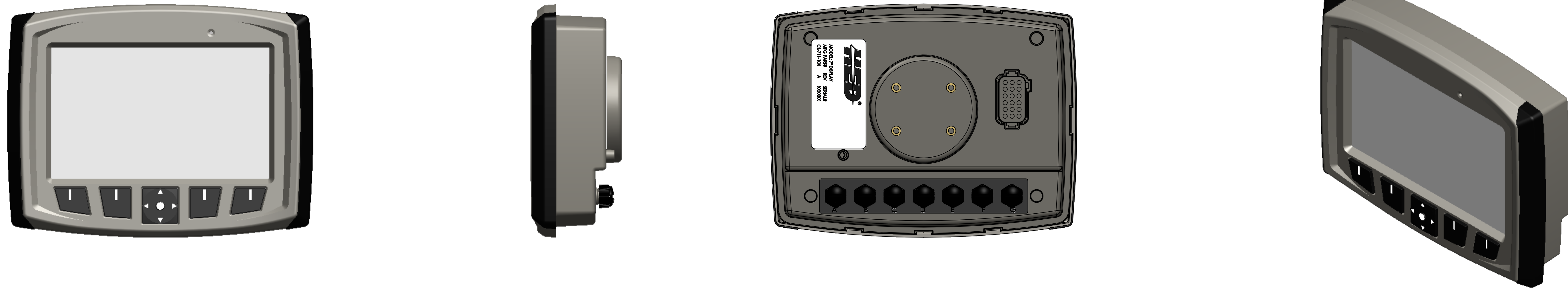

CL-711 GENII RETROFIT / FRONT MOUNT CONFIGURATION

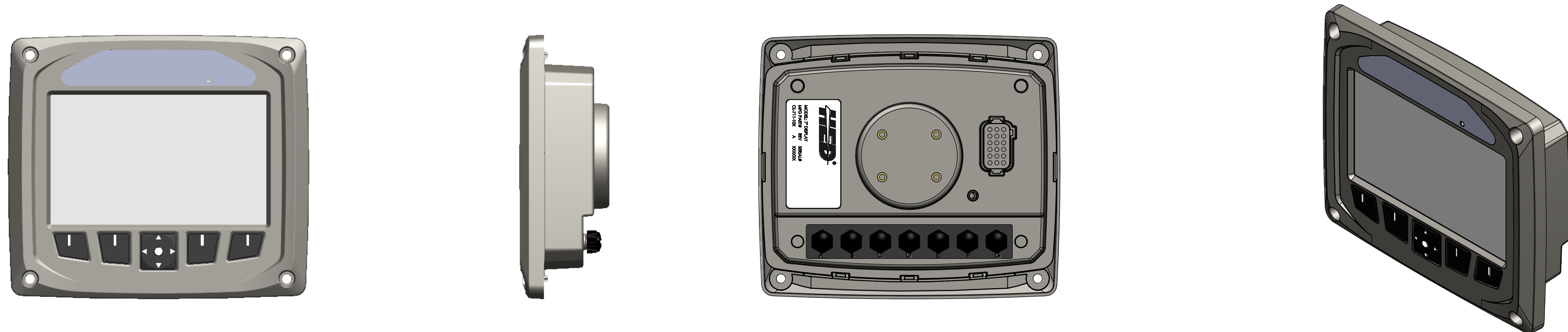

NOTES:

1. 3D MODELS IN STEP FORMAT AVAILABLE UPON REQUEST FOR ALL CONFIGURATIONS AND HED PARTS LISTED IN THIS DOCUMENT.
2. ALL DATA AND CONFIGURATIONS CONTAINED WITHIN THIS DOCUMENT IS FOR REFERENCE AND IS SUBJECT TO CHANGE WITHOUT PRIOR NOTICE OR PERMISSION.
3. FOR INFORMATION REGARDING PACKAGING OF THE DISPLAY NOT CONTAINED IN THIS DOCUMENT PLEASE CONTACT HED ENGINEERING.

UNLESS OTHERWISE SPECIFIED DIMENSIONS ARE IN INCHES. THIRD ANGLE PROJECTION
 UNLESS OTHERWISE SPECIFIED CAD DATABASE IS BASIC.
 DIMENSIONS ARE IN ACCORDANCE WITH
 ASME Y14.5M-1994. INTERPRET DRAWING
 IN ACCORDANCE WITH ASME Y14.100
 DO NOT SCALE. STANDARD MACHINING 1/32"
 PROPRIETARY AND CONFIDENTIAL

THE INFORMATION CONTAINED IN THIS DRAWING IS THE SOLE PROPERTY OF HYDRO ELECTRONIC DEVICES, INC. ANY REPRODUCTION IN PART OR AS A WHOLE WITHOUT THE WRITTEN PERMISSION OF HYDRO ELECTRONIC DEVICES, INC. IS PROHIBITED. © 2008 Hydro Electronic Devices, Inc. ALL RIGHTS RESERVED.

HED 2120 Constitution Avenue
 Hartford, Wisconsin 53027
 Phone (262) 673-9450
 www.hedonline.com

DWG NO: CL711100
DWG TITLE: CUSTOMER DRAWING, CL-711
REF: **DOC. CLASS:** CONFIDENTIAL
SIZE: D **SCALE:** N/A **SHEET:** 1 OF 4

CL-711 STANDARD CONFIGURATION

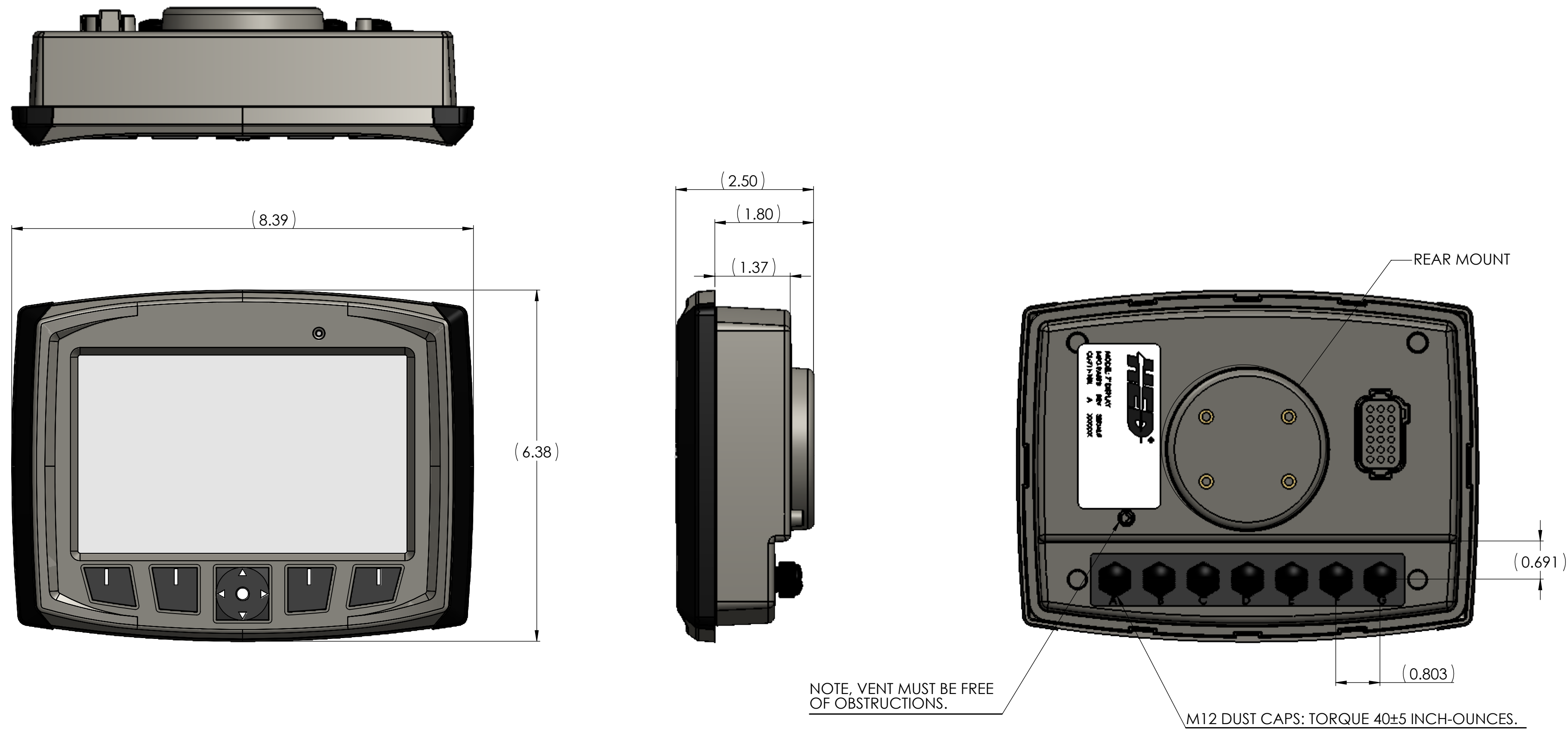

REAR MOUNT SPECIFICATIONS

BOLT PATTERN

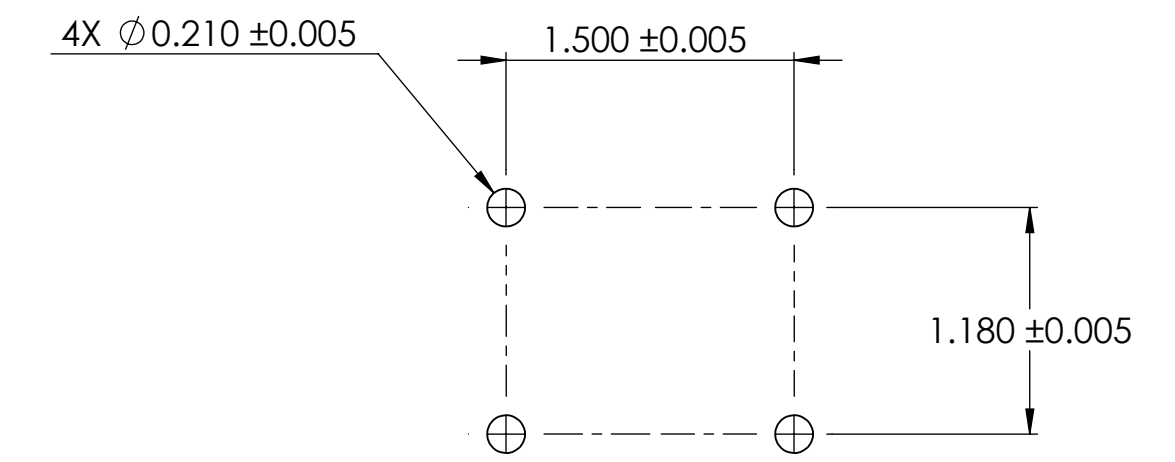

PANEL CUTOUT

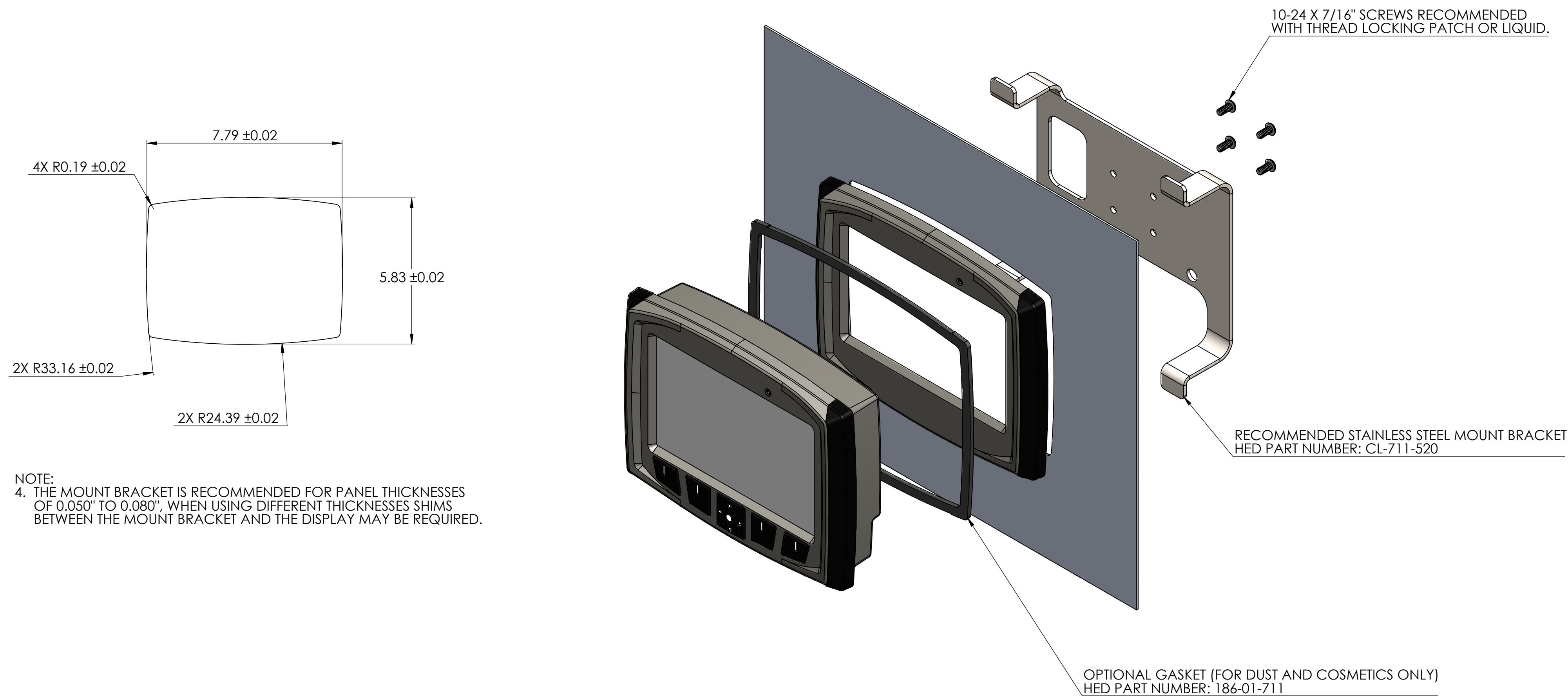

NOTE:
4. THE MOUNT BRACKET IS RECOMMENDED FOR PANEL THICKNESSES OF 0.050" TO 0.080". WHEN USING DIFFERENT THICKNESSES SHIMS BETWEEN THE MOUNT BRACKET AND THE DISPLAY MAY BE REQUIRED.

THREADED INSERT SPECIFICATIONS:

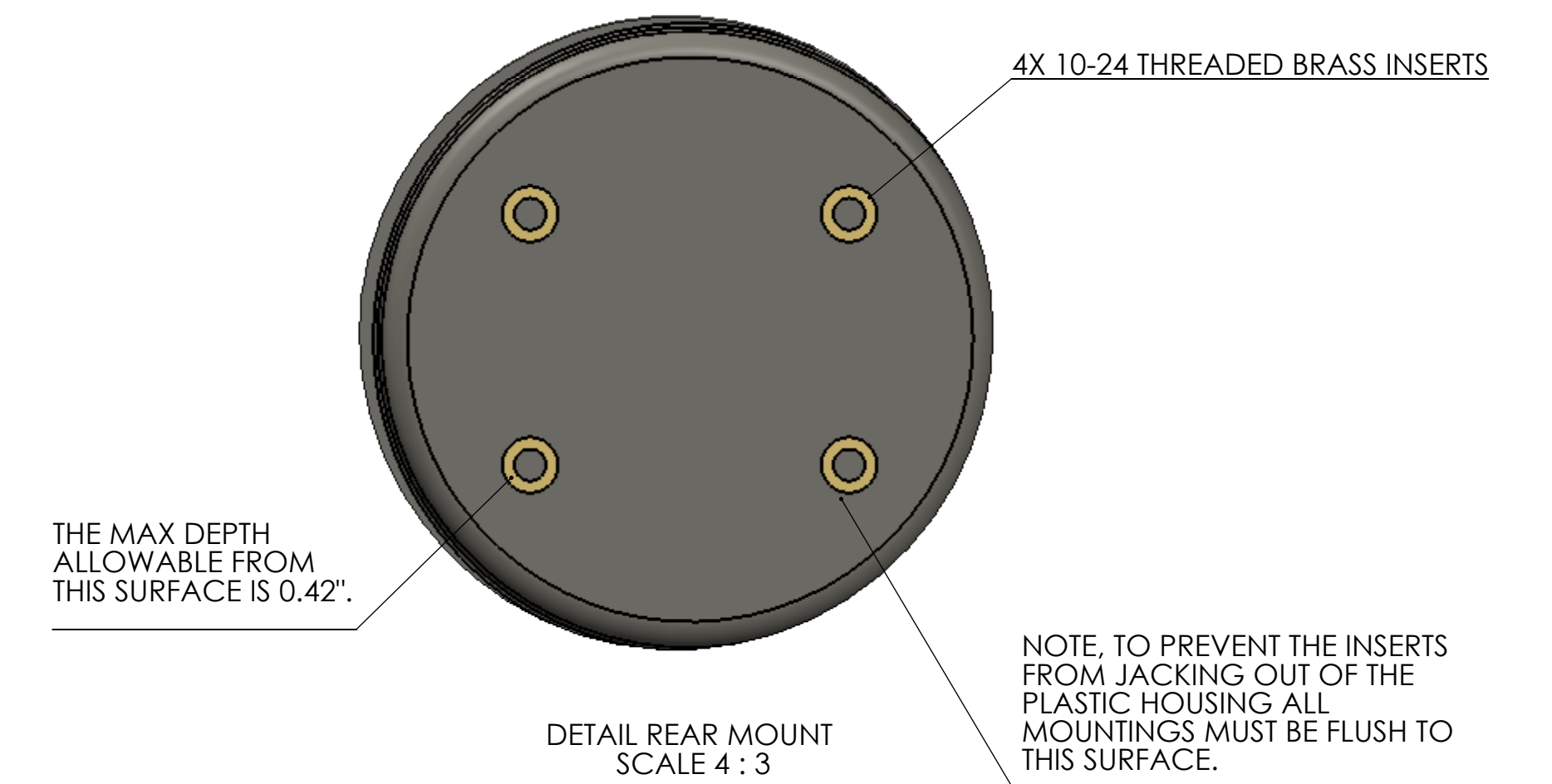

FASTENER TORQUE SPECIFICATION: 50 INLBS MAXIMUM.

(NON-PERMANENT THREAD LOCKING PATCH OR LIQUID RECOMMENDED)

- NOTES:
- HOLE PATTERN AND MOUNTING BASE IS COMPATIBLE WITH RAM® 2.43" DIAMETER BASES.
 - DISPLAY CAN COME WITH OPTIONAL MOUNT: RAM MOUNT® PART NUMBER: 202U

UNLESS OTHERWISE SPECIFIED DIMENSIONS ARE IN INCHES. THIRD ANGLE PROJECTION
UNLESS OTHERWISE SPECIFIED CAD DATABASE IS BASIC. DIMENSIONS ARE IN ACCORDANCE WITH ASME Y14.5M-1994. INTERPRET DRAWING IN ACCORDANCE WITH ASME Y14.100. DO NOT SCALE. STANDARD MACHINING 1/32"

THE INFORMATION CONTAINED IN THIS DRAWING IS THE SOLE PROPERTY OF HYDRO ELECTRONIC DEVICES, INC. ANY REPRODUCTION IN PART OR AS A WHOLE WITHOUT THE WRITTEN PERMISSION OF HYDRO ELECTRONIC DEVICES, INC. IS PROHIBITED. © 2008 Hydro Electronic Devices, Inc. ALL RIGHTS RESERVED.

HED 2120 Constitution Avenue
Hartford, Wisconsin 53027
Phone (262) 673-9450
www.hedonline.com

DWG NO: CL711100
DWG TITLE: CUSTOMER DRAWING, CL-711
REF: DOC. CLASS: CONFIDENTIAL
SIZE: D SCALE: N/A SHEET: 2 OF 4

CL-711 GENII RETROFIT / FRONT MOUNT CONFIGURATION

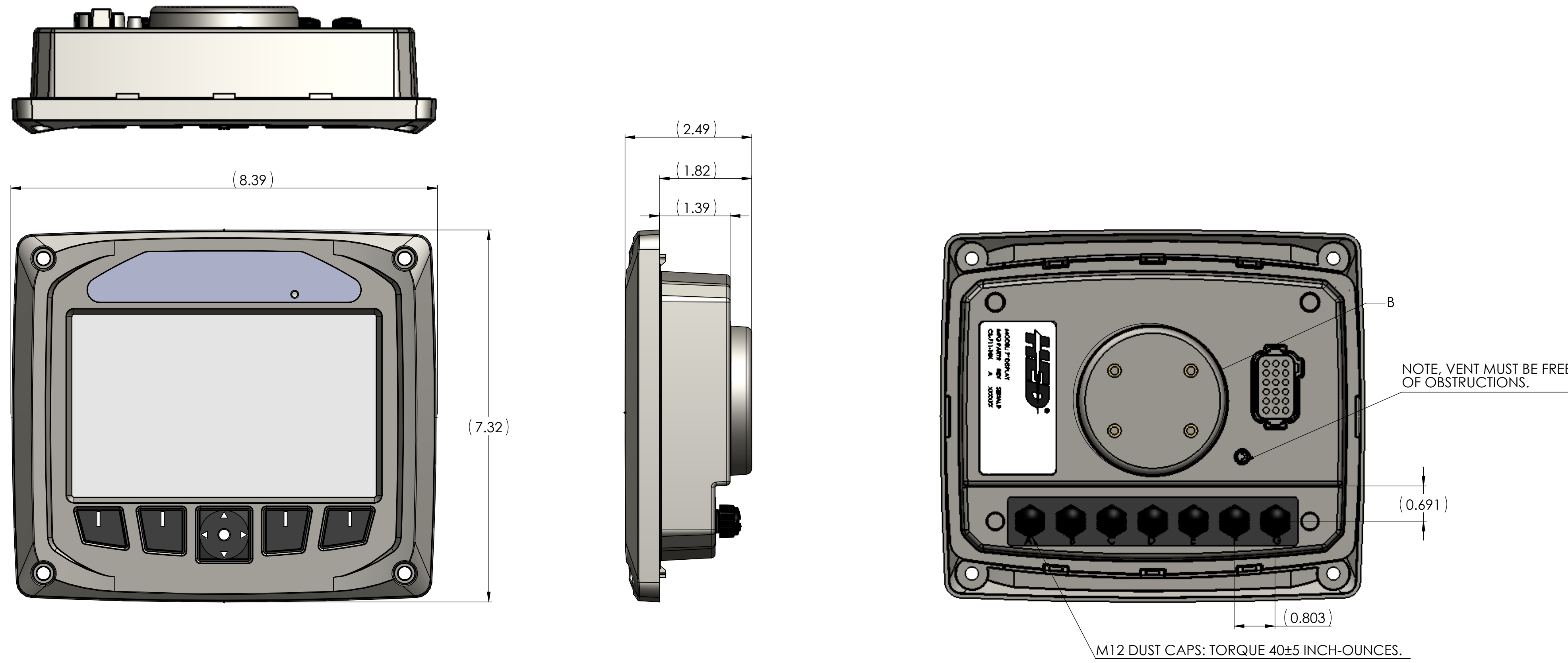

FRONT DECAL DESIGN

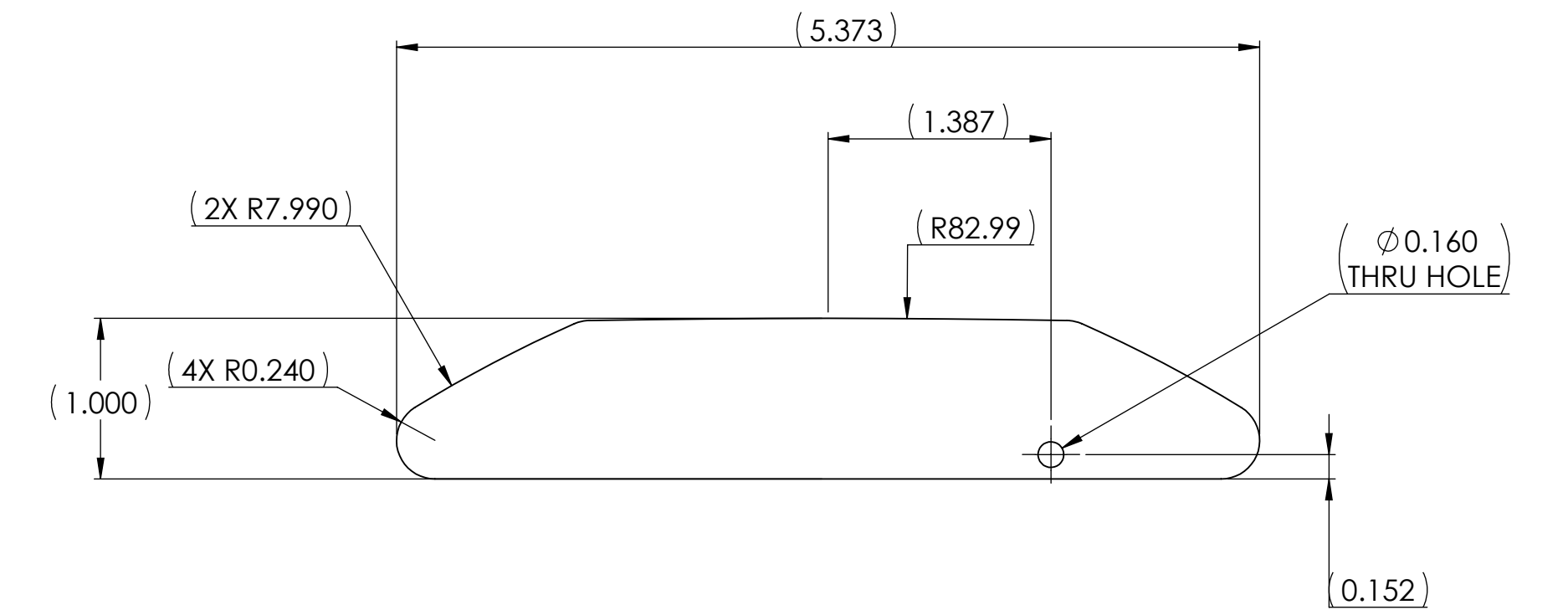

DECAL RECOMMENDATIONS:
 - MATERIAL: 10 MIL VELVET/MATTE LEXAN
 - MATERIAL: 3M 468MP (5 MIL 200MP ADHESIVE, 4 MIL LINER)

NEW PANEL CUTOUT

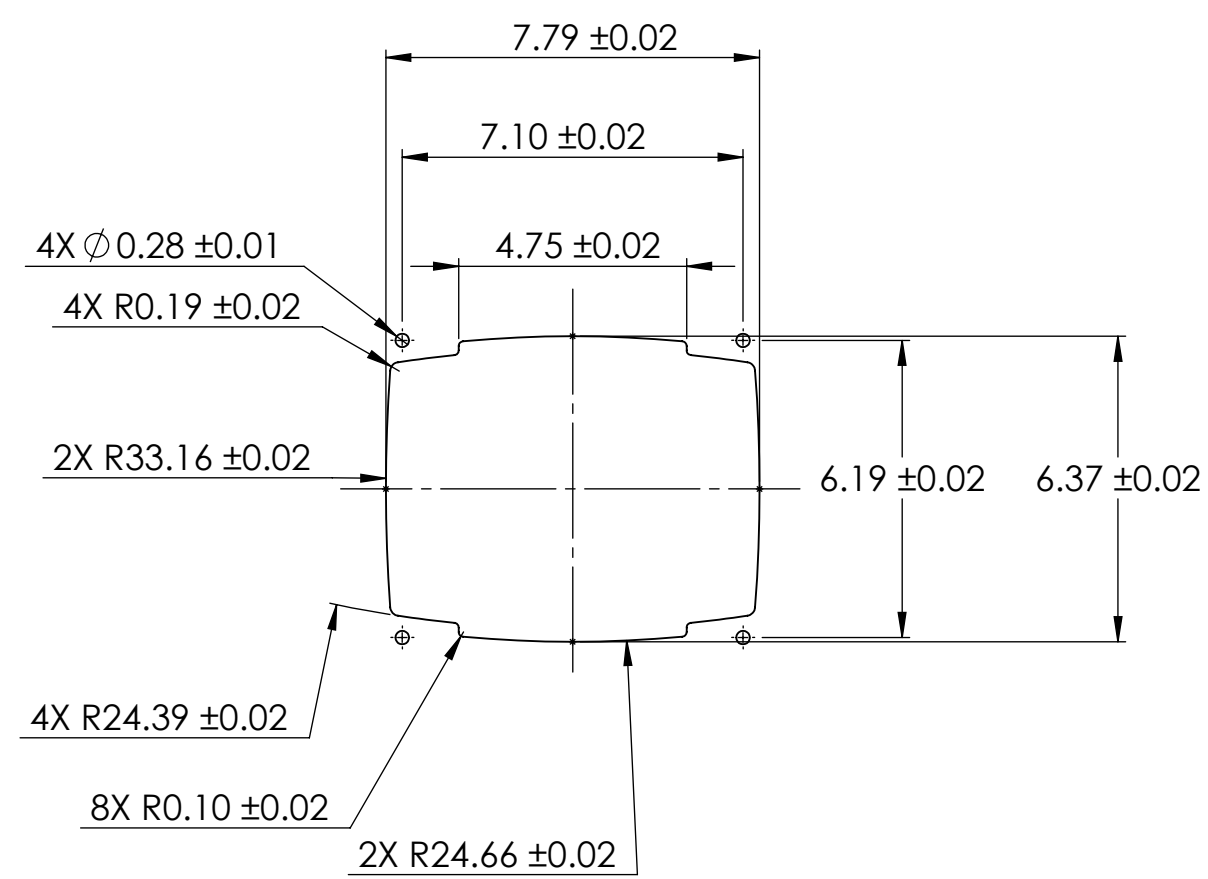

FASTENER TORQUE SPECIFICATION: 40 INLBS MAXIMUM.

(NON-PERMANENT THREAD LOCKING PATCH OR LIQUID RECOMMENDED)

1/4-20 SOCKET HEAD SCREWS RECOMMENDED WITH THREAD LOCKING PATCH OR LIQUID.

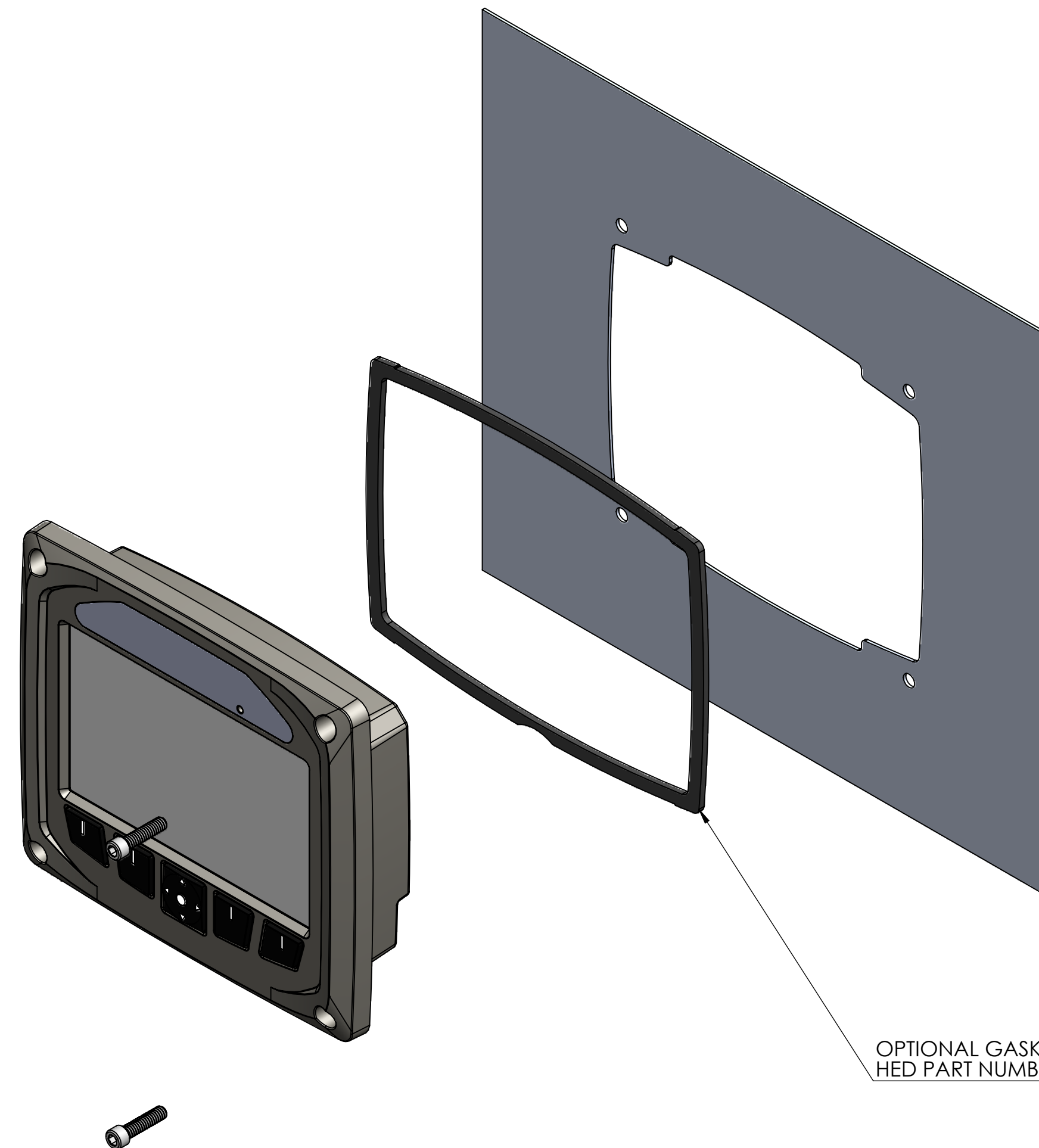

OPTIONAL GASKET (FOR DUST AND COSMETICS ONLY)
 HED PART NUMBER: 186-01-711

UNLESS OTHERWISE SPECIFIED DIMENSIONS ARE IN INCHES. DIMENSIONS ARE IN ACCORDANCE WITH ASME Y14.5M-1994. INTERPRET DRAWING IN ACCORDANCE WITH ASME Y14.100. DO NOT SCALE. STANDARD MACHINING. PROPRIETARY AND CONFIDENTIAL.

THE INFORMATION CONTAINED IN THIS DRAWING IS THE SOLE PROPERTY OF HYDRO ELECTRONIC DEVICES, INC. ANY REPRODUCTION IN PART OR AS A WHOLE WITHOUT THE WRITTEN PERMISSION OF HYDRO ELECTRONIC DEVICES, INC. IS PROHIBITED. © 2008 Hydro Electronic Devices, Inc. ALL RIGHTS RESERVED.

HED 2120 Constitution Avenue
 Hartford, Wisconsin 53027
 Phone (262) 673-9450
 www.hedonline.com

DWG NO: CL711100
 DWG TITLE: CUSTOMER DRAWING, CL-711
 REF: DOC. CLASS: CONFIDENTIAL
 SIZE: D SCALE: N/A SHEET: 3 OF 4

OTHER CUSTOMIZATIONS:

NO BUTTON FACEPLATE



NO BUTTON VARIANT AVAILABLE IN STANDARD CONFIGURATION ONLY.

SCREEN PRINTING ON BEZEL:

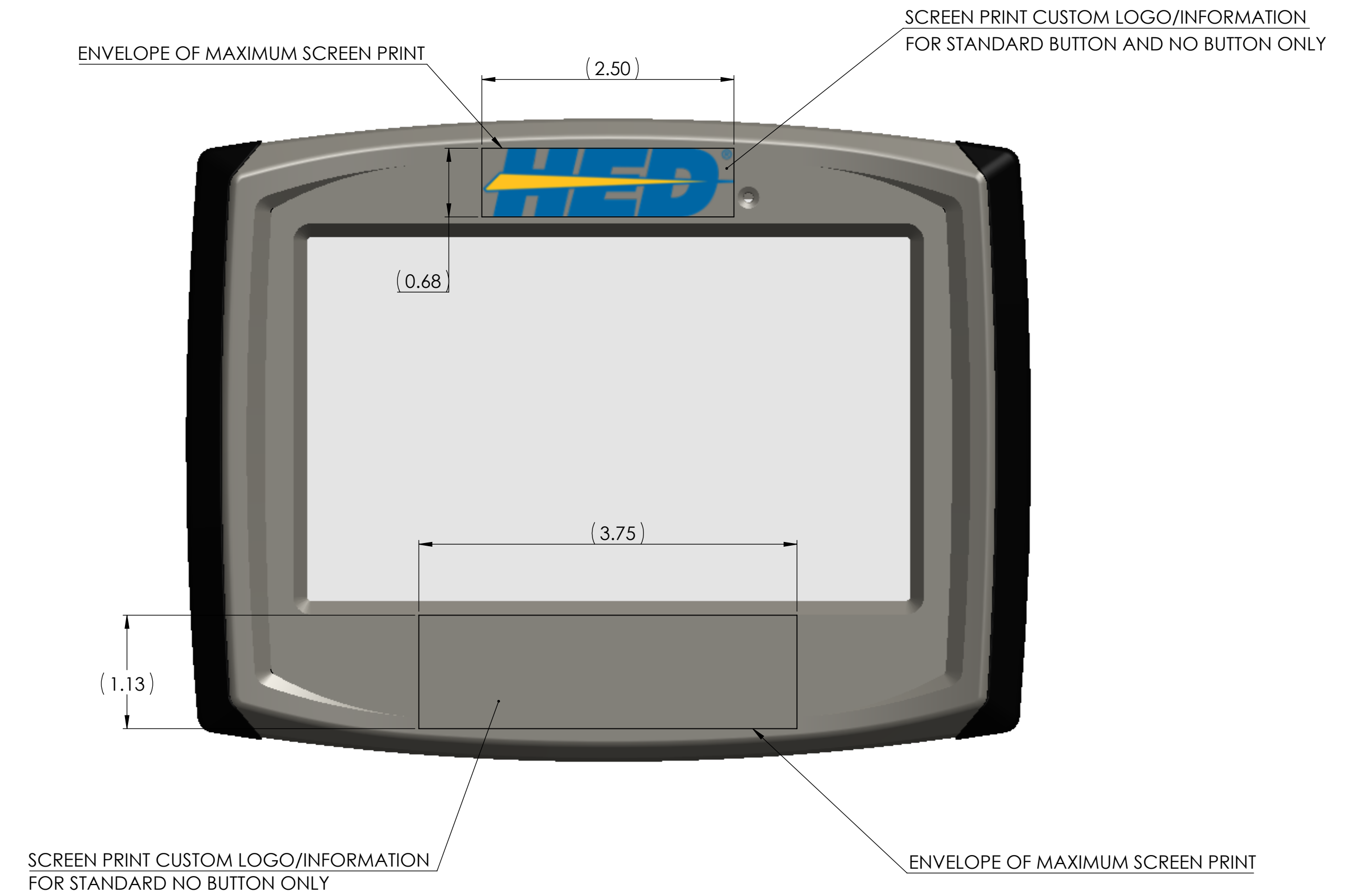

LASER ETCHED BUTTONS:

STANDARD BUTTON LASER ETCH



EXAMPLE OF CUSTOM LASER ETCH



AVAILABLE IN STANDARD AND FRONT MOUNT CONFIGURATIONS.

5 BUTTON OPTION:



NOTE, BOTH OF THESE OPTIONS ARE 9 BUTTON OPTIONS, THE CUSTOME LASER ETCHING ALSO APPLYS TO THE 5 BUTTON OPTION.

UNLESS OTHERWISE SPECIFIED DIMENSIONS ARE IN INCHES. THIRD ANGLE PROJECTION
 UNLESS OTHERWISE SPECIFIED, CAD DATABASE IS BASIC.
 DIMENSIONS ARE IN ACCORDANCE WITH ASME Y14.5Y-1994. INTERPRET DRAWING IN ACCORDANCE WITH ASME Y14.100
 DO NOT SCALE. STANDARD MACHINING. PROPRIETARY AND CONFIDENTIAL.

THE INFORMATION CONTAINED IN THIS DRAWING IS THE SOLE PROPERTY OF HYDRO ELECTRONIC DEVICES, INC. ANY REPRODUCTION IN PART OR AS A WHOLE WITHOUT THE WRITTEN PERMISSION OF HYDRO ELECTRONIC DEVICES, INC. IS PROHIBITED. © 2008 Hydro Electronic Devices, Inc. ALL RIGHTS RESERVED.

HED 2120 Constitution Avenue
 Hartford, Wisconsin 53027
 Phone (262) 673-9450
 www.hedonline.com

DWG NO: CL711100
 DWG TITLE: CUSTOMER DRAWING, CL-711
 REF: DOC. CLASS: CONFIDENTIAL
 SIZE: D SCALE: 1:1 SHEET: 4 OF 4
 Rev. 3 12/21/2016