



## CANLink® CL-607-1XX 2x6 Keypad Sealed CAN Keypad Family

### Special Features include:

- (12) Multiplexed rubber membrane pushbuttons
  - Also available: 2x3, 2x4 & 4x3 keypads
- Sealed construction (IP67)
- Long life: 1million+ key presses
- Large 0.75" x 0.75" buttons
- Capable of detecting multiple simultaneous key presses
- Dimmable LED indicators (via CAN or Analog Input)
- Dimmable LED backlit icons (via CAN or Analog Input)
- Optional Power LED indicator
- Customizable button labeling / icons
- Customizable LED indicator location & color
  - 3 LED indicators per button
  - 1 LED indicator between each pair of buttons
    - used for bar graph feature
- Optional 2<sup>nd</sup> Connector for one of following features:
  - Easy daisy-chain connection of multiple keypads
  - 4 pins for various combinations of Inputs / Outputs
  - 4 pins can be used as harness code inputs
- (1) J1939 CAN port

The HED® CL-607 is a solid-state microprocessor based keypad module that is a member of the HED® CANLink® multiplex control family. It provides a versatile, programmable, and highly visible operator interface.

Designed for use as part of a distributed system, the CL-607 can dramatically reduce vehicle dashboard wiring, and can be programmed with a dimming function.

Each button is available in various colors. Additionally, buttons can be programmed to flash codes for simple troubleshooting and warning indications.

The HED® CL-607 can be programmed using HED's do-it-yourself CANLink® Composer™ programming tool or directly by HED® engineering, and is designed for use with the CANLink® Conductor™ software tool for diagnostics and field troubleshooting.

### Specifications

|                               |  |
|-------------------------------|--|
| Mating Connectors:<br>Deutsch | DT06-4S (with W4SA wedge)<br>DT06-4S (with W4SB wedge)<br>0462-201-16141 16AWG Sockets   |
| Operating Voltage Range:      | 8 to 32 VDC  |
| Operating Temperature:        | -40°C to 70°C  |
| Storage temperature:          | -40°C to 85°C  |
| IP Rating                     | IP67   |
| PC Boards:                    | The printed circuit boards are designed for high EMI/RFI protection.<br>The boards are conformal coated with a silicone coating for further water/moisture protection.<br>All inputs and outputs are protected against shorts to Battery(+) or Battery(-).<br>100% of the boards are functionally tested before shipment.<br><br>* Harness codes are switch to ground inputs used to identify I/O module location and function to the master controller. |

## CL-607 2x6 Keypad

### A Connector

#### Deutsch DT06-4PA 4-pin Connector

| Pin | Function                                 |
|-----|--|
| 1   | BAT(+) Module /<br>Input Battery Voltage |
| 2   | BAT(-) Module                            |
| 3   | CAN-H                                    |
| 4   | CAN-L                                    |

### B Connector Option #1

#### Deutsch DT06-4PB 4-pin Connector

| Pin | Function  |
|-----|---|
| 1   | Input STB / STG / AIN or<br>Output DOUT/PWM/ECC(+) (2A) |
| 2   | Input STB / STG or<br>Output DOUT/PWM/ECC(+) (2A)       |
| 3   | Input STB / STG or<br>Output DOUT/PWM/ECC(+) (2A)       |
| 4   | Input STB / STG or<br>Output DOUT/PWM/ECC(+) (2A)       |

### B Connector Option #2

#### Deutsch DT06-4PB 4-pin Connector

| Pin | Function      |
|-----|---------------|
| 1   | BAT(+) Module |
| 2   | BAT(-) Module |
| 3   | CAN-H         |
| 4   | CAN-L         |

### Composer I/O Assignments for Button Inputs & LED Outputs

- Composer Input numbering for each Button is shown on drawing.
- Composer Output numbering for each LED indicator is shown on drawing.

Note: Different feature combinations are available. Please refer to specific CL-605-1XX data sheet for feature number designations for use within Composer™. Data sheets available on HED® website.

Note: 2A Output PWM frequency is limited to max of 500Hz. Duty cycle range limited to: 10% to 90%.

Note: This B connector configuration allows for daisy-chaining of wire harnesses for applications using multiple CL-607 keypads. When daisy chaining, customer is required to install 10A fuse to initial +Battery feeding first keypad.

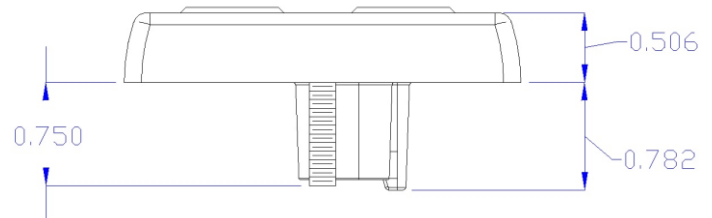
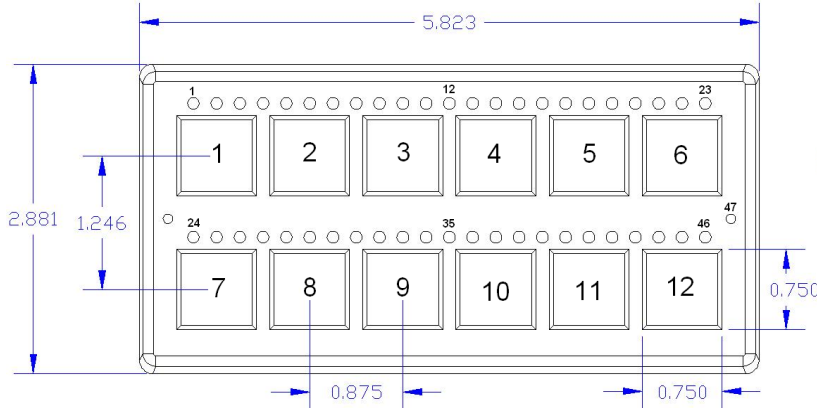

### Mounting Torque:

10-18 in-lbs

Note: Lock washer should be utilized

